

CLEANING and INSPECTION

110

1. Place carburetor body in a carburetor cleaning solution for a short period of time to remove all dirt, gum and varnish which may have accumulated.

NOTE: Carburetor cleaners are available through local automotive supply stores.

2. After removing carburetor from cleaner, rinse thoroughly in clean solvent and blow off with compressed air. Be sure to blow through all passages, orifices and nozzles.

3. Check float for deterioration.

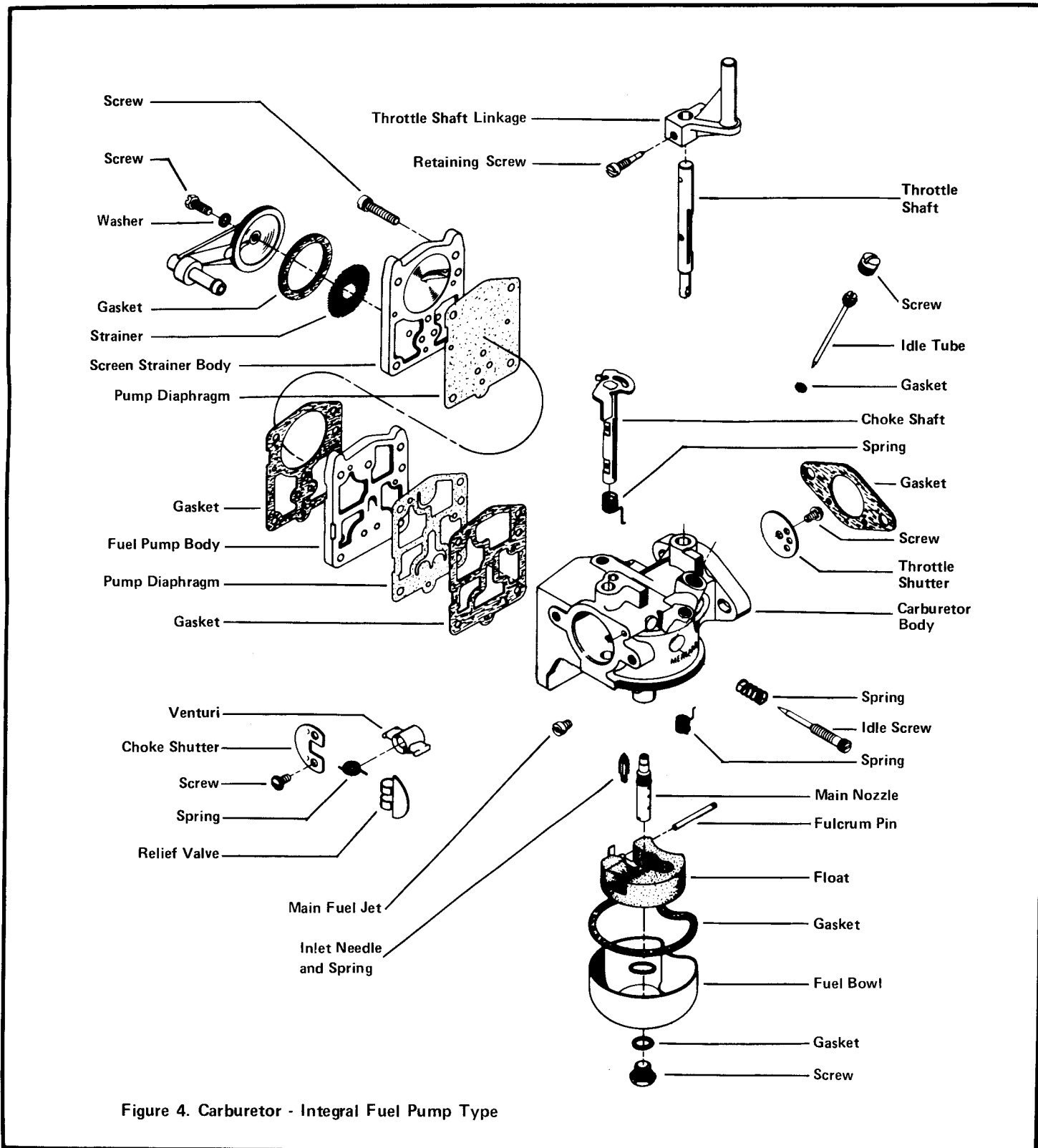

Figure 4. Carburetor - Integral Fuel Pump Type